

LEGEND

- PROPERTY BOUNDARY
- LOT BOUNDARY LINES
- UTILITY EASEMENT
- SET ALUMINUM CAP
- FOUND BRASS CAP
- FOUND ALUMINUM CAP
- SET CENTERLINE MONUMENT

CERTIFICATE OF DEDICATION

STATE OF WYOMING)) SS
 COUNTY OF PARK))

Know all persons by these presents, that Royal Construction Inc. is the owner of a parcel of land located in Lot 628, 1504', R289H, 6th P.M., Park County, Wyoming.

Said parcel of land being more particularly described as follows:

Beginning at the northwest corner of said Lot 628; thence S89°14'19"E on and along the north line of said Lot 628 for a distance of 1312.07 feet more or less to the northeast corner of said Lot 628; thence S00°00'50"W on and along the east line of said Lot 628 for a distance of 340.00 feet; thence N89°14'19"E for a distance of 168.00 feet; thence N00°00'50"E for a distance of 21.75 feet; thence N89°14'19"E for a distance of 878.34 feet to the southeast corner of said Lot 628; thence S89°14'19"E on and along the west line of Lot 628 for a distance of 282.53 feet more or less to the POINT OF BEGINNING; said parcel containing 9.23 acres more or less.

That we have caused said described land to be surveyed and platted as shown in the attached map and that the Whispering Pines Subdivision located within the City of Powell, Park County, Wyoming, is shown thereon and that the same is in accordance with the desires of the undersigned owners and proprietors; and that we hereby dedicate and set apart the easements and public lands with the purpose no noted hereon for the public use.

[Signature]
 Royal Construction Inc.
 President - Royal Construction Inc.

The foregoing certificate was acknowledged before me this _____ day of _____, 2008.
 My commission expires: _____

Notary Public

 My commission expires: 13-13-08

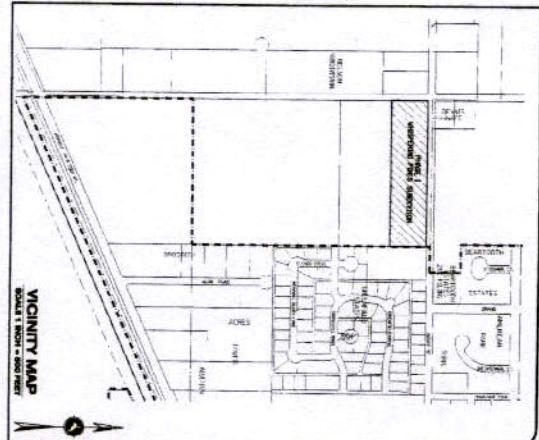

CERTIFICATE OF SURVEYOR

STATE OF WYOMING)) SS
 COUNTY OF PARK))

I, Paul R. Campbell of Cody, Wyoming hereby certify that this map is based upon field and record data and that it is an accurate plat of Phase I of the Whispering Pines Subdivision located in Township 120N, R. 60W, 6th P.M. City of Powell, Park County, Wyoming.



PAUL R. CAMPBELL
 WYOMING REGISTRATION NO. 2871 L.S.

COUNTY CLERK'S CERTIFICATE

This plat was filed for the public record in the office of the Clerk, Park County, Wyoming, at 10:00 A.M. on the _____ day of _____, 2008, and is duly recorded in Book _____ Page Number _____ Sec. 4 2nd - 2549

KAREN DICKER
 Park County Clerk

By: *[Signature]*
 Deputy

1. Reading these for this survey is S89°14'19"E along the north line of
2. Computed to be set after construction is complete.

APPROVALS

STATE OF WYOMING)) SS
 COUNTY OF PARK))

City Planning and Zoning Board

Recommended for approval this 25 day of *March*, 2008 by the City Planning and Zoning Board of Powell, Wyoming.

By Chairman *[Signature]*
 Carol Richmond

Approved this 21 day of *March*, 2008 by the City Council of Powell, Wyoming.

By Mayor *[Signature]*
 Scott Marshall



Attested by City Clerk *[Signature]* *[Signature]*
 Kyrice K. Erickson

AMENDED PLAT

PHASE I OF THE WHISPERING PINES SUBDIVISION

PREPARED BY: SAPE

REGISTERED PROFESSIONAL SURVEYOR

1500 W. 10TH ST. SUITE 100
 POWELL, WYOMING 82424

PHASE I OF THE WHISPERING PINES SUBDIVISION

PREPARED BY: SAPE

REGISTERED PROFESSIONAL SURVEYOR

1500 W. 10TH ST. SUITE 100
 POWELL, WYOMING 82424